

TC Total Care

Complete Purifying Treatment for A/C systems, Cockpits and Interiors



Product description

TOTAL CARE is a complete purifying treatment specifically designed to clean and purify A/C systems and vehicle interiors, removing microorganisms that are harmful to health and leaving a pleasant feeling of cleanliness. It can also be used to purify splits and interiors. Thanks to its foam formulation, EVAPORATOR CLEANER FOAM adheres perfectly to the evaporator fins and the surfaces of the ventilation ducts, removing dirt and all the microorganisms that contaminate the A/C system, causing bad smells and possible diseases. Its long cannula allows it to reach deep into the air conditioning system, ensuring the best product distribution. As the foam increases in volume, it purifies the air ducts, incorporating and expelling all contaminating particles (dust, dirt, allergens and microorganisms) that may reduce air quality.

INTERIOR PURIFIER purifies the air and all surfaces in the passenger compartment or surrounding area, removing any scattered contaminating particles and releasing a pleasant scent. Its continuous flow saturates the environment with the product, reaching even the most difficult-to-reach surfaces without wetting or leaving residues.

TOTAL CARE is available in 7 pleasant fragrances: Talc, Strawberry, Peach, Mint, Lemon, Vanilla and Green Apple.

Features

- Purifies vehicle A/C systems and passenger compartments.
- Purifies indoor units and rooms.
- Purifies air ducts.
- Removes contaminating particles.
- Ready to use.
- Does not wet and leaves no residue.
- Scented.

Interiors Application

STEP 1: EVAPORATOR CLEANER FOAM

1. Turn off the A/C system.
2. Shake the can.
3. Apply the product on the entire surface to be treated:
4. Wipe with a soft cloth, where necessary.
5. Wait until the foam disappear before running the system normally.

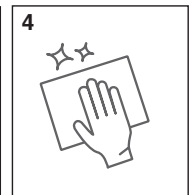
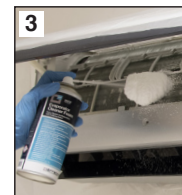
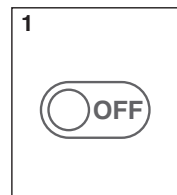

STEP 2: INTERIOR PURIFIER

1. Shake the can.
2. Place the can in the middle of the room.
3. Make sure there are no people or pets inside the room to be treated.
4. Press the button on the top of the can, close doors and windows and wait for the product to empty completely.
5. Wait 10 minutes.
6. Ventilate the room for 10 minutes before entering.



Vehicle Application

STEP 1: EVAPORATOR CLEANER FOAM

1. Remove the cabin filter.
2. Shake the can.
3. Insert the cannula into the ventilation ducts
4. Dispense the product until the foam comes out from the air ducts.
5. To completely purify the air duct, slowly move the cannula backwards during dispensing.
6. Wait until the foam has completely dissolved before switching the system on again.



STEP 2: INTERIOR PURIFIER

1. Shake the can.
2. Place the can on the passenger side car mat.
3. Make sure there are no people or pets inside the car.
4. Press the recirculation mode button.
5. Press the button on the top of the can, close doors and windows and wait for the product to empty completely.
6. Wait 10 minutes.
7. Ventilate the cockpit for 10 minutes before entering.



Packaging available

	Talc Art.-Nr.	Strawberry Art.-Nr.	Peach Art.-Nr.	Mint Art.-Nr.	Lemon Art.-Nr.	Vanilla Art.-Nr.	Green Apple Art.-Nr.	€	♻️
200 mL	RKAB37.S1	RKAB38.S1	RKAB39.S1	RKAB36.S1	RKAB40.S1	RKAB41.S1	RKAB42.S1	-	



Hazard Statements



Warning

Hazard Statements: H222+H229 Extremely flammable aerosol. Pressurized container: may burst if heated. H319 Causes serious eye irritation.

Precautionary statements: P210 Keep away from heat, hot surfaces, sparks, open flames and other ignition sources. No smoking. P211 Do not spray on an open flame or other ignition source. P251 Do not pierce or burn, even after use. P410+P412 Protect from sunlight. Do not expose to temperatures exceeding 50 °C/122 °F.

Professional usage product. Don't stay into the room during treatment. Pressurized can: way burst if heated.